

REINFORCEMENT :

ALL WALLS & FLOORS MESH REINF.
TO METRIC FABRIC NO.245.
WALLS 150 mm THICK
FLOOR 100 mm THICK.

DETAIL 34b

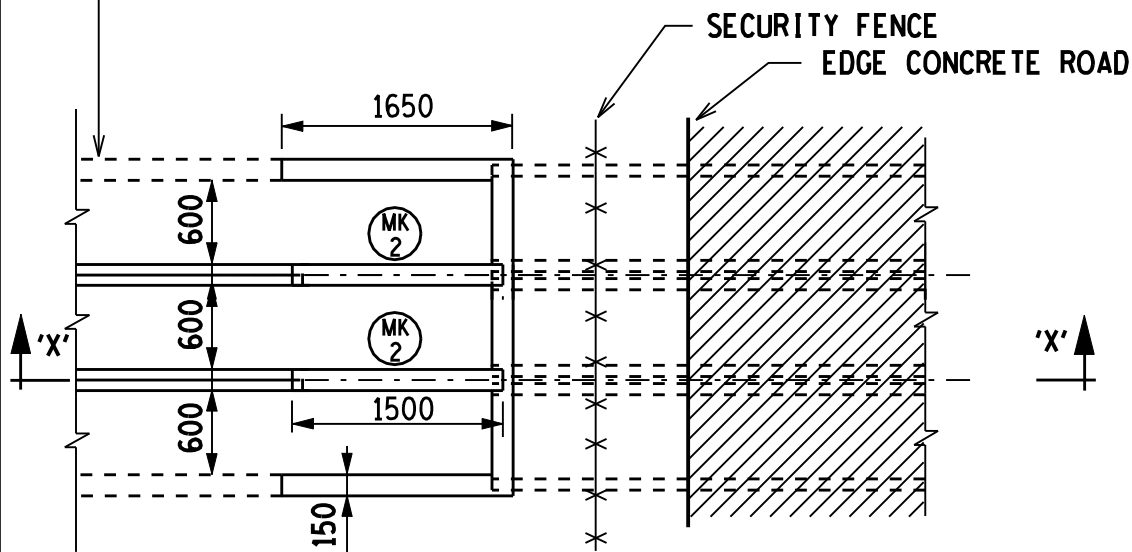
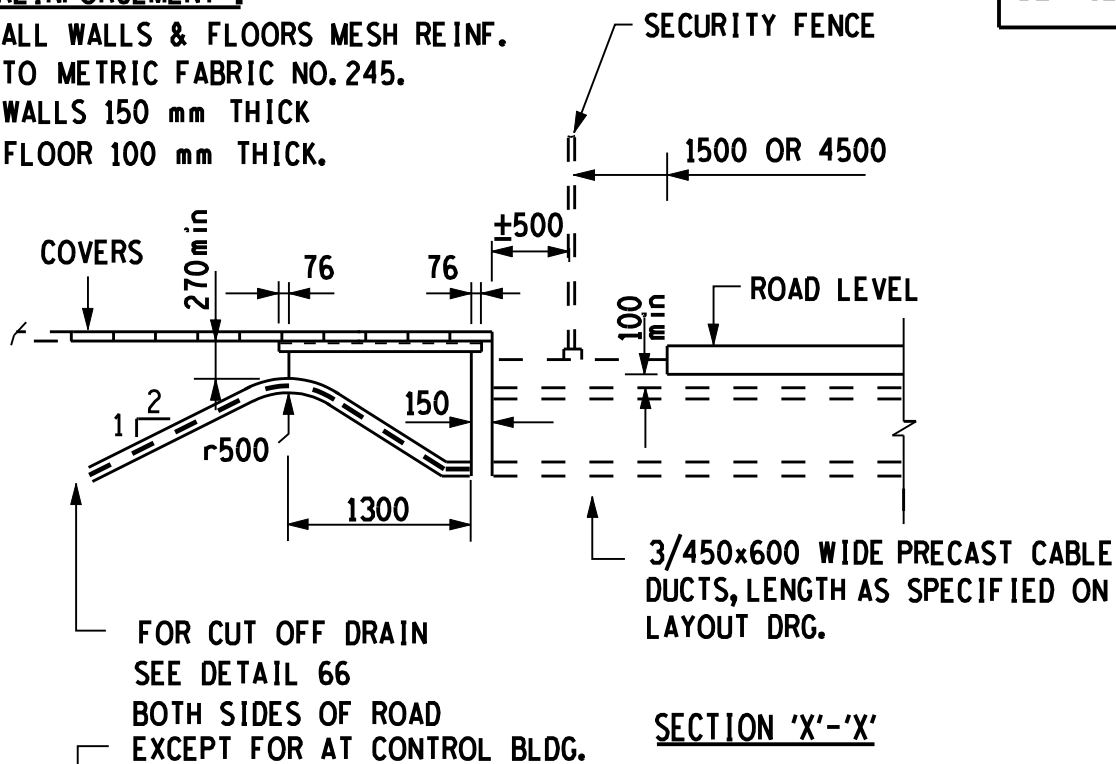

SECTIONAL PLAN

N.T.S.

CABLE TRENCH

TRIPPLE CABLE TRENCH CROSSING ROAD

THE C.A.D. REFERENCE NUMBER IS :
MUTS0.54/00390K33.R05

TRANSMISSION
SUBSTATION
TECHNOLOGY
DEPARTMENT



ESKOM

DRAWN
GETEKEN

DJC.S

15/1/99

CHKD
NAGES

DB.N.

15/1/99

AUTH
MAS

REV

0

DATE
DATUM

H V YARD CIVIL WORK
STANDARD DETAILS

0.54/390

SHEET 34b

DRG.TEK
REGISTR

A4L